



Cylinders

- System K
- 6 Pin
- 5 Pin
- Security Roses

Cylinders

UNION[®]



Cylinders



Cylinders Index

- **Introduction** C2
- **BSEN1303 Classification** C3
- **Features and Functions** C3
- **Photo Gallery** C4
- **Range Table** C5
- **Euro Profile Cylinders** C6
- **Single Cylinders**
- **Double Cylinders**
- **Turn & Key Cylinders**
- **Oval Profile Cylinders** C7
- **Single Cylinders**
- **Double Cylinders**
- **Turn & Key Cylinders**
- **Rim Cylinders** C8
- **Mortice Screw in Cylinders** C8
- **Scandinavian Cylinders** C9
- **Inner Cylinder**
- **Outer Cylinder**
- **Security Escutcheons** C9
- **Product Information Tables** C10-11

Note: We have made every effort to ensure that at the time of going to print all information shown in this catalogue is correct. However, in our efforts to continually improve our products and offer only the highest levels of security and quality we reserve the right to make alterations to the product specifications shown in this catalogue. All dimensions provided within this catalogue are approximate and for guidance only.

Introduction

Union offers a very comprehensive range of cylinders to suit most applications. They are available in the most common styles to enable the customer to utilise their existing ironmongery.

The patent protection on the new System K will help secure your system from illicit key duplication, and is available with the new Fast Response Centre Service Support.

For the most comprehensive and flexible range of cylinders, Union has the solution.



Union is accredited with and meets the requirements of BS EN ISO 9001: 1994.

Keying Groups

Throughout the catalogue you will see a column headed.



The information shown under this heading can help you identify which products can be Keyed Alike or Masterkeyed.

The products that can be keyed to work with other products are given a group code.

KA - means the product can be **Keyed Alike** with more of the same product.

MK - means the product can be **Masterkeyed** with more of the same product.

A Group Letter (eg **A**) means the product can be **Keyed Alike** or **Masterkeyed** with more of the same product and with other products listed in the same group.

For the complete range of products and their keying groups, see the chart in the introduction section.

Keys

2 keys are supplied as standard, however see the price list for any variations.

How to Specify

Union have developed a series of icons to enable the process of product specification to be simplified.

From today you can specifically detail your requirements for a product, therefore ensuring that it includes particular security features.

Example: If you require a cylinder that is Drill Resistant look for the Drill icon (2) in the range table.

Union, Simplifying the Specification Process.

Standards & Approvals









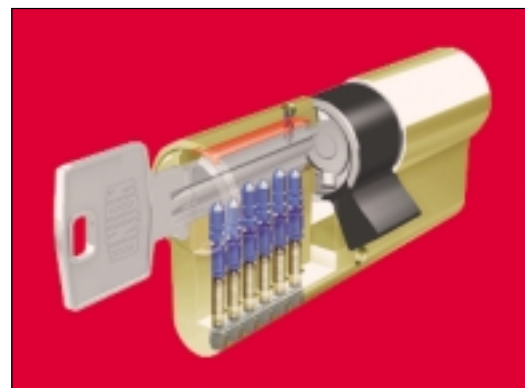



These pan-European standards classify products into grades on a series of exacting tests.



The Association of British Insurers provides minimum security recommendations for external doors and windows.



Security Features

- 1  **Protected Section**
Products are available as an option on a patented key section.
- 2  **Drill Resistant**
Hardened protection against drill attack.
- 3  **Saw Resistant**
Hardened protection against saw attack.
- 4  **Force Resistant**
Built in strength against force attack.
- 5  **Pick Resistant**
Built in protection to resist picking.
- 6  **Torque Resistant**
Built in strength against torque attack.
- 7  **Tamper Resistant**
Built in protection against Tampering.
- 8  **Corrosion Resistant**
Products conform to appropriate anti-corrosion requirements.
- 9  **Fire Resistant**
Products conform to appropriate fire test requirements.
- 10  **Escape**
Products for use on an escape door.
- 11  **Key Control**
The products can be included in a key control system.
- 12  **Guarantee**
Products are guaranteed for a period of time.



Cylinders



BSEN1303 Classification

This standard classifies cylinders using a 7 digit coding system. Each digit refers to a particular feature of the product measured against the standard's performance requirements.

- Digit 1 - Category of use** - grade 1: Suitable for use at extremes of temperature - 20°C to +80°C.
- Digit 2 - Durability** - grade 4: 25 000 cycles completed.
- grade 5: 50 000 cycles completed.
- grade 6: 100 000 cycles completed.
- Digit 3 - Door mass** No requirement.
- Digit 4 - Fire resistance** - grade 0: No requirement.
- grade 1: Cylinders shall be fire tested in accordance with current fire test requirements of prEN 1634-1.
- Digit 5 - Safety** No requirement.
- Digit 6 - Corrosion resistance** - grade 0: No requirement.
- grade 1: Conforms to grade 3 of BS EN 1670 as a minimum.
- Digit 7 - Security** Cylinders will be classified in grades 1 to 5, where 5 is the highest. The grade of security can differ from one side of a double cylinder to the other.

	Grades				
	1	2	3	4	5
Min. no. of effective differs	100	300	15 000	30 000	100 000
Min. no. of movable pins	2	3	5	6	6
Direct coding on key	YES	YES	NO	NO	NO
Max. net drill time (mins.)	-	-	-	3	5
Total drill test time (mins)	-	-	-	5	10
* Chisel attack resistance (No. of blows)	-	-	-	30	40
Cylinder extraction resistance	-	-	-	15kN	15kN
* Cylinder torque resistance (Nm)	2.5	5	15	20	30

Example
The following marking denotes a cylinder meeting the required category of use, durability grade 6 (100 000 cycles) with no fire resistance requirement, grade 1 corrosion resistance and grade 4 security.

1 6 - 0 - 1 4

* **Note:** To gain chisel or torque resistance it is important that either, (1) the correct length of cylinder is used to be flush with the door/handle face OR (2) a high security rose is used to cover any cylinder protrusion.

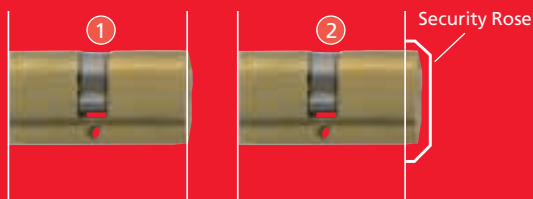

Features and Functions

Adjustable Cam

The System K Euro Single cylinder has an adjustable cam which can easily be set to one of eight positions

Retaining Screw Anti Drill

The System K Rim cylinder has hardened anti-drill plates positioned in front of the two retaining screws which prevent drilling out of the rim cylinder retaining screws from the outside.



Products have been tested to BSEN1303 and graded.

Number of Keys

2 keys are supplied as standard, however see the price list for any variations.

Key Systems



SYSTEM K
Newly patented High Security locking system. The system operates on 7 pins in the cylinder, one of which interacts with a pin fitted in key.



5 & 6 PIN
Convenient system for commercial applications. System operates on a row of five or six lateral pins.



Products meet the minimum ABI security recommendations.

- Protected Section**
Available on a patented key section.
- Drill Resistant**
Hardened Steel Inserts in the cylinder body and plug.
- Force Resistant**
Security roses or correct length cylinders prevent force attacks.
- Pick Resistant**
Mushroom pins in the cylinder inhibit picking.
- Torque Resistant**
Security roses or correct length cylinders prevent twisting.
- Corrosion Resistant**
Products have successfully completed an anti-corrosion test.
- Key Control**
Cylinders using the same key systems can be supplied Keyed Alike, or Masterkeyed.
- Guarantee**
Guarantee period applicable when used with original Union keys and maintenance instructions followed.

Special Length Cylinders

Cylinders greater than 'D' length are available up to a maximum length of 110mm per side. For details and pricing please consult Customer Services.

Finishes: Brass | Satin Nickel | Satin Chrome

Ideal for Use with: Rim Locks, Mortice Locks, Access Control, Panic Hardware, Multipoint Locks.



Cylinders



Euro Profile Cylinders



UNION Euro Single Cylinder Page C6



UNION Euro Double Cylinder Page C6



UNION Euro Key and Turn Cylinder Page C6

Rim Cylinders

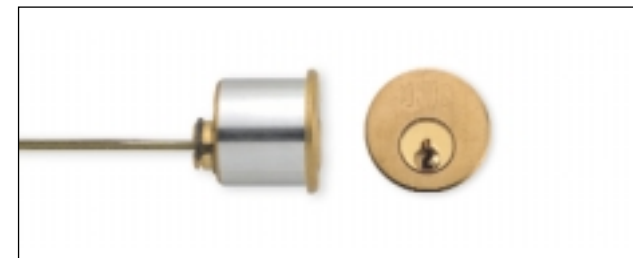

UNION SKR Page C8

Oval Profile Cylinders



UNION Oval Single Cylinder Page C7

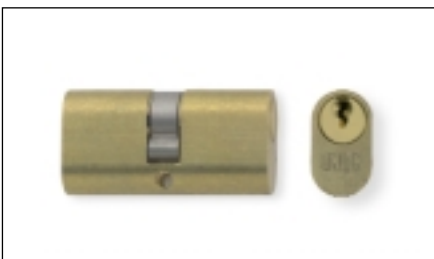

UNION Oval Double Cylinder Page C7



UNION Oval Key and Turn Cylinder Page C7

Rim Cylinders



UNION 1 x 10S Page C8

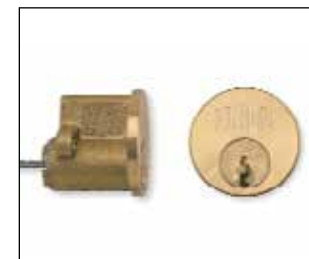

UNION 1 x 1 Page C8

Screw In Cylinders



UNION SKTC • 2X11 Page C8

Scandinavian Oval Cylinders



UNION SKSCI Page C9



UNION SKSCO Page C9

Security Roses and Escutcheons



UNION 53046 • 53043 • 53045 Page C9



UNION 530TSE Page C9

	Standards		Security Features								Key Systems			Features & Functions			Finish Options		
	ADI	CEN	Protected Section	Drill Resistant	Force Resistant	Pick Resistant	Torque Resistant	Corrosion Resistant	Key Control	Guarantee	5 Pin	6 Pin	SYSTEM K	Paracentric Keyway	Std. Cam Position	Other	Brass	Satin Nickel	Satin Chrome
UNION Euro Profile Cylinders*																			
Euro Single Cylinder								●	●	C	10				30°		●		●
Euro Single Cylinder	o			o	o	o	●	●	B	10		●			30°		●		●
SKES Euro Single Cylinder	●	116-10-115	●	●	●	●	●	●	A	10			●	●	30°	AC	●	●	
Euro Double Cylinder								●	●	C	10				30°		●		●
Euro Double Cylinder	o			o	o	o	●	●	B	10		●			30°		●		●
SKED Euro Double Cylinder	●	116-10-115	●	●	●	●	●	●	A	10			●	●	30°		●	●	
Euro Key and Turn Cylinder								●	●	C	10		●		30°		●		●
Euro Key and Turn Cylinder								●	●	B	10		●		30°		●		●
SKET Euro Key and Turn Cylinder	●	116-10-115	●	●	●	●	●	●	A	10			●	●	30°		●	●	
UNION Oval Profile Cylinders*																			
Oval Single Cylinder								●	●	C	10				30°		●		●
Oval Single Cylinder	o			o	o	o	●	●	B	10		●			30°		●		●
SKOS Oval Single Cylinder	●	116-10-115	●	●	●	●	●	●	A	10			●	●	30°		●	●	
Oval Double Cylinder								●	●	C	10				30°		●		●
Oval Double Cylinder	o			o	o	o	●	●	B	10		●			30°		●		●
SKOD Oval Double Cylinder	●	116-10-115	●	●	●	●	●	●	A	10			●	●	30°		●	●	
Oval Key and Turn Cylinder								●	●	C	10		●		30°		●		●
Oval Key and Turn Cylinder								●	●	B	10		●		30°		●		●
SKOT Oval Key and Turn Cylinder	●	116-10-115	●	●	●	●	●	●	A	10			●	●	30°		●	●	
UNION Rim Cylinders																			
1 X 1								●	●		10						●		●
1 X 1 OS								●	●	C	10						●		●
1 X 1 OS • 16 x 1	o			o	o	o	●	●	B	10		●					●		●
SKR	●	116-10-115	●	●	●	●	●	●	A	10			●	●		RSAD	●	●	
UNION Mortice Screw-in Cylinders																			
2 X 11A								●	●	C	10						●		●
2 X 11B								●	●	C	10						●		●
2 X 11C								●	●	C	10						●		●
2 X 11B • 26 x 11B	o			o	o	o	●	●	B	10		●					●		●
2 X 11C • 26 x 11C	o			o	o	o	●	●	B	10		●					●		●
SKTC	●	116-10-115	●	●	●	●	●	●	A	10			●	●			●	●	
UNION Scandinavian Oval Cylinders																			
SKSCI25	●	116-10-115	●	●	●	●	●	●	A	10			●	●			●	●	
SKSC025	●	116-10-115	●	●	●	●	●	●	A	10			●	●			●	●	
SKSCI30	●	116-10-115	●	●	●	●	●	●	A	10			●	●			●	●	
SKSC030	●	116-10-115	●	●	●	●	●	●	A	10			●	●			●	●	

Key: RSAD = Retaining Screw Anti-Drill AC = Adjustable Cam O = Available in High Security Variant only

* See product information tables for details of list numbers and length variations.



Cylinders



Euro Profile Single Cylinders

UNION SKES • 2 X 20 • 2 X 39 • 26 X 20 See product information tables for details of list numbers and length variations.

- For use with Euro profile lock cases.
- Gives key access from one side of a door.



Euro Profile Double Cylinders

UNION SKED • 2 X 18 • 26 X 18 See product information tables for details of list numbers and length variations.

- For use with Euro profile lock cases.
- Gives key access from both sides of a door.



Euro Profile Key & Turn Cylinders

UNION SKET • 2 X 19 • 2 X 28 • 2 X 71 See product information tables for details of list numbers and length variations.

- For use with Euro profile lock cases.
- Gives key access from one side of a door and thumbturn operation from the other.

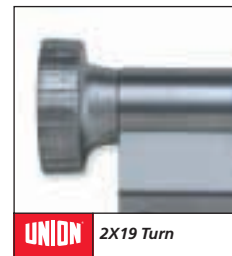

	Euro Single			Euro Double			Euro Turn		
	5	6	SK	5	6	SK	5	6	SK
Security Features									
Protected Section			•			•			•
Drill Resistant		○	•		○	•			•
Force Resistant		○	•		○	•			•
Pick Resistant		○	•		○	•			•
Torque Resistant	•	•	•	•	•	•	•	•	•
Corrosion Resistant	•	•	•	•	•	•	•	•	•
Key Control	C	B	A	C	B	A	C	B	A
Guarantee	10	10	10	10	10	10	10	10	10
Key Systems									
5 Pin	•			•			•		
6 Pin		•			•			•	
System K			•			•			•
Features & Functions									
Paracentric Keyway			•			•			•
Std. Cam Position	30°	30°	30°	30°	30°	30°	30°	30°	30°
Other			AC						
Finish Options									
Brass	•	•	•	•	•	•	•	•	•
Satin Nickel			•			•			•
Satin Chrome	•	•		•	•		•	•	



Cylinders



Oval Profile Single Cylinders

UNION SKOS • 2 X 8 • 26 X 8 See product information tables for details of list numbers and length variations.

- For use with Oval profile lock cases.
- Gives key access from one side of a door.



Oval Profile Double Cylinders

UNION SKOD • 2 X 6 • 26 X 6 See product information tables for details of list numbers and length variations.

- For use with Oval profile lock cases.
- Gives key access from both sides of a door.



Oval Profile Key & Turn Cylinders

UNION SKOT • 2 X 13 • 2 X 29 • 2 X 69 • 26 X 13 See product information tables for details of list numbers and length

- For use with Oval profile lock cases.
- Gives key access from one side of a door and thumbturn operation from the other.



	Oval Single			Oval Double			Oval Turn		
	5	6	SK	5	6	SK	5	6	SK
Security Features									
Protected Section			•			•			•
Drill Resistant		O	•		O	•			•
Force Resistant		O	•		O	•			•
Pick Resistant		O	•		O	•			•
Torque Resistant	•	•	•	•	•	•	•	•	•
Corrosion Resistant	•	•	•	•	•	•	•	•	•
Key Control	C	B	A	C	B	A	C	B	A
Guarantee	10	10	10	10	10	10	10	10	10
Key Systems									
5 Pin	•			•			•		
6 Pin		•			•			•	
System K			•			•			•
Features & Functions									
Paracentric Keyway			•			•			•
Std. Cam Position	30°	30°	30°	30°	30°	30°	30°	30°	30°
Other									
Finish Options									
Brass	•	•	•	•	•	•	•	•	•
Satin Nickel			•			•			•
Satin Chrome	•	•		•	•		•	•	



Cylinders



Rim Cylinders

UNION SKR

- For use with surface mounted locks operating from a tailbar.
- Provide key access from one side of a door.
- Suitable for doors from 38mm to 57mm in thickness.

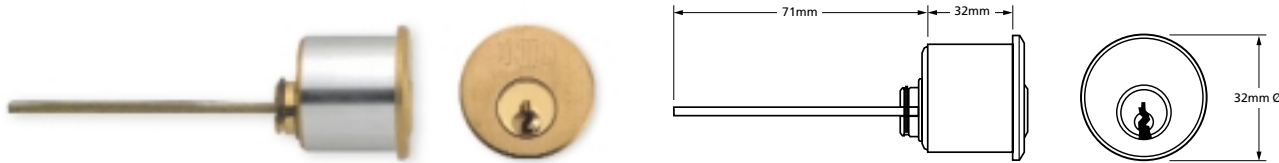

Rim Cylinders

UNION 1 X 1 • 1 X 10S • 16 X 10S

- For use with surface mounted locks operating from a tailbar.
- Provide key access from one side of a door.

* High Security Cylinder with Anti Drill and Anti Pick.

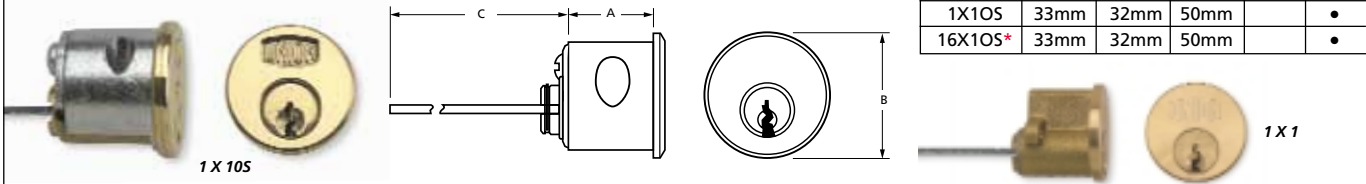

Model	A	B	C	5 PIN	6 PIN
1X1	23mm	33mm	48mm	•	
1X10S	29mm	32mm	50mm	•	
1X10S	33mm	32mm	50mm		•
16X10S*	33mm	32mm	50mm		•

Mortise Screw in Cylinders

UNION SKTC • 2 X 11 • 26 X 11

- For use with American stile or narrow stile mortise locks operating from a 29mm threaded cylinder.
- Provide key access from one side of a door.

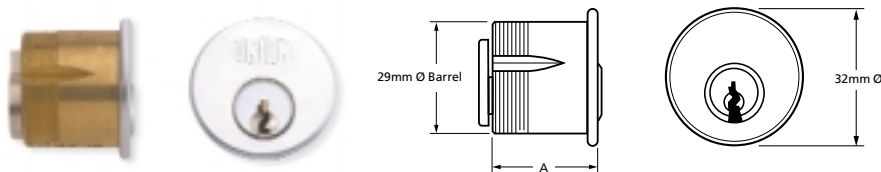

Model	A	5 PIN	6 PIN	SYSTEM K
SKTC	32mm			•
2X11A	28.5mm	•		
2X11B	33mm	•	•	
2X11C	37mm	•	•	
26X11B*	33mm		•	
26X11C*	37mm		•	

* High Security Cylinder with Anti Drill and Anti Pick.

	1 X 1 1 X 10S	1 X 10S 16 X 1	SKR	2 X 11A 2 X 11B 2 X 11C	2 X 11B 26 X 11B 2 X 11C 26 X 11C	SKTC
Security Features						
Protected Section			•			•
Drill Resistant		○	•		○	•
Force Resistant		○	•		○	•
Pick Resistant		○	•		○	•
Torque Resistant	•	•	•	•	•	•
Corrosion Resistant	•	•	•	•	•	•
Key Control	C (1X10S)	B	A	C	B	A
Guarantee	10	10	10	10	10	10
Key Systems						
5 Pin	•			•		
6 Pin		•			•	
System K			•			•
Features & Functions						
Paracentric Keyway			•			•
Std. Cam Position						
Other			RSAD			
Finish Options						
Brass	•	•	•	•	•	•
Satin Nickel			•			•
Satin Chrome	•	•		•	•	

Scandinavian Oval Cylinders

UNION SKSCI

- For use with Scandinavian oval profile lock cases.
- Provides key access from the inside of a door.
- Bolt through fixings.

LIST No.	LENGTH A
SKSCI25	25
SKSCI30	30

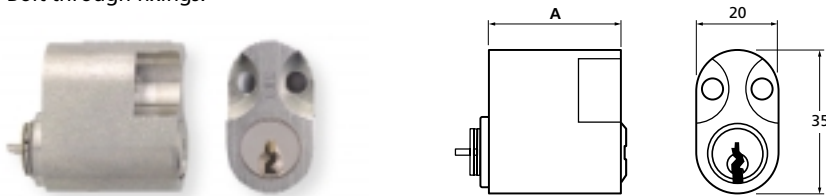

UNION SKSCO

- For use with Scandinavian oval profile lock cases.
- Provides key access from the outside of the door.
- Bolt through fixings.

LIST No.	LENGTH A
SKSC025	25
SKSC030	30

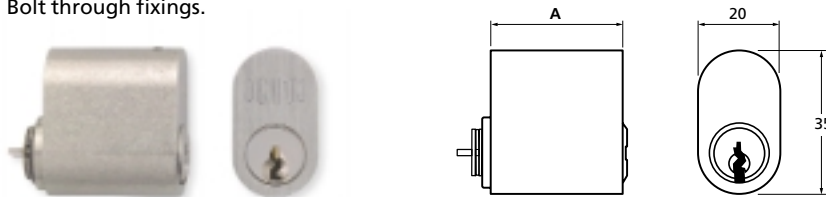

High Security Cylinder Roses and Escutcheons

UNION 53046 • 53053 • 53045 • 53043

- For use with Euro and Oval profile cylinders.
- Helps prevent against Torque and Force attacks.
- Brass or Satin Finish.
- Bolt through fixing.



UNION 530TSE

- For use with Euro profile cylinders.
- Helps prevent against Torque and Force attacks.
- Brass or Satin Finish.
- Bolt through fixing.
- Escutcheon covers cylinder for extra protection.

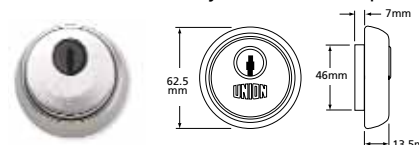

	SKSCI	SKSCO	
Security Features			
Protected Section	•	•	
Drill Resistant	•	•	
Force Resistant	•	•	
Pick Resistant	•	•	
Torque Resistant	•	•	
Corrosion Resistant	•	•	
Key Control	A	A	
Guarantee	10	10	
Key Systems			
5 Pin			
6 Pin			
System K	•	•	
Features & Functions			
Paracentric Keyway	•	•	
Std. Cam Position			
Other			
Finish Options			
Brass	•	•	
Satin Nickel	•	•	
Satin Chrome			



Cylinders



Product Information Tables (for page C6)

UNION Euro Profile Cylinders

Euro Single Cylinders

Model	System K	6 PIN	5 PIN	A	B	C
SKES3010	•			30	10	40
SKES3510	•			35	10	45
SKES4010	•			40	10	50
SKES4510	•			45	10	55
2X20A			•	32	8	40
2X20B		•	•	37	8	45
2X20C		•	•	41	8	49
2X20D		•	•	45	8	53
26X20B*		•		37	8	45
26X20C*		•		41	8	49
26X20D*		•		45	8	53

* High Security Cylinder with Anti Drill and Anti Pick.

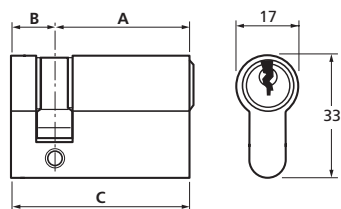

SKES • 2 X 20 • 26 X 20



Euro Double Cylinders

Model	System K	6 PIN	5 PIN	A	B	C
SKED3030	•			30	30	60
SKED3535	•			35	35	70
SKED4040	•			40	40	80
SKED4545	•			45	45	90
2X18AA			•	32	32	64
2X18AB			•	32	37	69
2X18AC			•	32	41	73
2X18AD			•	32	45	77
2X18BB		•	•	37	37	74
2X18BC		•	•	37	41	78
2X18BD		•	•	37	45	82
2X18CC		•	•	41	41	82
2X18CD		•	•	41	45	86
2X18DD		•	•	45	45	90
26X18BB*		•		37	37	74
26X18CC*		•		41	41	82
26X18DD*		•		45	45	90

* High Security Cylinder with Anti Drill and Anti Pick.

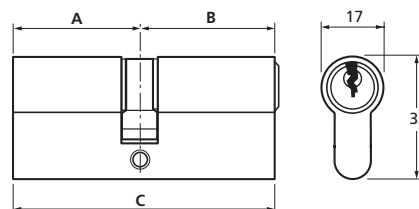

SKED • 2 X 18 • 26 X 18

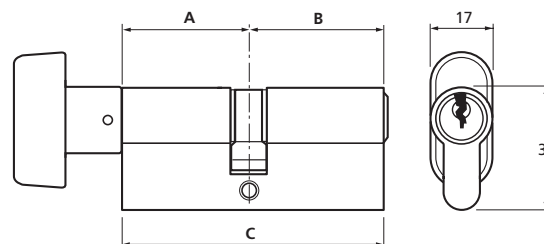

SKET • 2 X 28 • 2 X 29 • 2 X 71

Euro Key & Turn Cylinders

Model	System K	6 PIN	5 PIN	A	B	C
SKET3030	•			30	30	60
SKET3535	•			35	35	70
SKET4040	•			40	40	80
SKET4545	•			45	45	90
2X28AA			•	32	32	64
2X28AB		•	•	32	37	69
2X28AC		•	•	32	41	73
2X28AD		•	•	32	45	77
2X28BB		•	•	37	37	74
2X28BA		•	•	37	32	69
2X28BC		•	•	37	41	78
2X28BD		•	•	37	45	82
2X28CC		•	•	41	41	82
2X28CA			•	41	32	73
2X28CB		•	•	41	37	78
2X28CD		•	•	41	45	86
2X29AA		•	•	32	32	64
2X29AB		•	•	32	37	69
2X29AC		•	•	32	41	73
2X29AD		•	•	32	45	77
2X29BA		•	•	37	32	69
2X29CA		•	•	41	32	73
2X29DA		•	•	45	32	77
2X71AA			•	32	32	64
2X71AB		•	•	32	37	69
2X71AC		•	•	32	41	73
2X71AD		•	•	32	45	77
2X71BB		•	•	37	37	74
2X71BA		•	•	37	32	69
2X71BC		•	•	37	41	78
2X71BD		•	•	37	45	82
2X71CC		•	•	41	41	82
2X71CA			•	41	32	73
2X71CB		•	•	41	37	78
2X71CD		•	•	41	45	86

Note: Dimensions shown in mm (rounded to the nearest whole number for guidance only).



Cylinders



Product Information Tables (for page C7)

UNION Oval Profile Cylinders

Oval Single Cylinders

Model	System K	6 PIN	5 PIN	A	B	C
SKOS3010	•			30	10	40
SKOS3510	•			35	10	45
SKOS4010	•			40	10	50
SKOS4510	•			45	10	55
2X8A			•	32	8	40
2X8B		•	•	37	8	45
2X8C		•	•	41	8	49
2X8D		•	•	45	8	53
26X8B*		•		37	8	45
26X8C*		•		41	8	49
26X8D*		•		45	8	53
2X1A			•	32	8	40
2X1B		•	•	37	8	45
2X1C		•	•	41	8	49
2X1D		•	•	45	8	53

* High Security Cylinder with Anti Drill and Anti Pick.

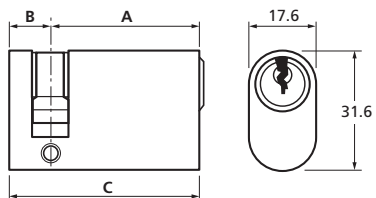

SKOS • 2 X 8 • 26 X 8 • 2 X 1



Note: Dimensions shown in mm (rounded to the nearest whole number for guidance only).

Oval Double Cylinders

Model	System K	6 PIN	5 PIN	A	B	C
SKOD3030	•			30	30	60
SKOD3535	•			35	35	70
SKOD4040	•			40	40	80
SKOD4545	•			45	45	90
2X6AA			•	32	32	64
2X6AB			•	32	37	69
2X6AC			•	32	41	73
2X6AD			•	32	45	77
2X6BB		•	•	37	37	74
2X6BC		•	•	37	41	78
2X6BD		•	•	37	45	82
2X6CC		•	•	41	41	82
2X6CD		•	•	41	45	86
2X6DD		•	•	45	45	90
26X6BB*		•		37	37	74
26X6CC*		•		41	41	82
26X6DD*		•		45	45	90

* High Security Cylinder with Anti Drill and Anti Pick.

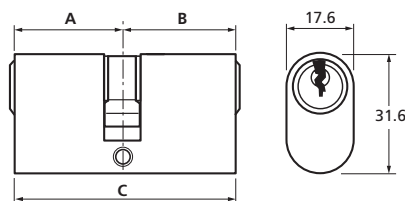

SKOD • 2 X 6 • 26 X 6

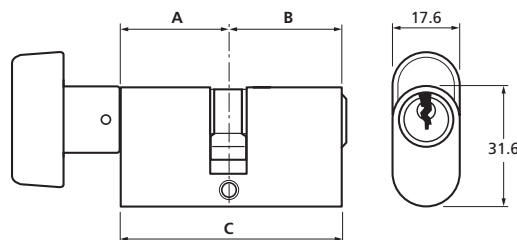

SKOT • 2 X 13 • 2 X 29 • 2 X 69

Oval Key & Turn Cylinders

Model	System K	6 PIN	5 PIN	A	B	C
SKOT3030	•			30	30	60
SKOT3535	•			35	35	70
SKOT4040	•			40	40	80
SKOT4545	•			45	45	90
2X13AA			•	32	32	64
2X13AB		•	•	32	37	69
2X13AC		•	•	32	41	73
2X13AD		•	•	32	45	77
2X13BB		•	•	37	37	74
2X13BA			•	37	32	69
2X13BC		•	•	37	41	78
2X13BD		•	•	37	45	82
2X13CC		•	•	41	41	82
2X13CA			•	41	32	73
2X13CB		•	•	41	37	78
2X13CD		•	•	41	45	86
2X29AA		•	•	32	32	64
2X29AB		•	•	32	37	69
2X29AC		•	•	32	41	73
2X29AD		•	•	32	45	77
2X29BA		•	•	37	32	69
2X29CA		•	•	41	32	73
2X29DA		•	•	45	32	77
2X69AA			•	32	32	64
2X69AB		•	•	32	37	69
2X69AC		•	•	32	41	73
2X69AD		•	•	32	45	77
2X69BB		•	•	37	37	74
2X69BA			•	37	32	69
2X69BC		•	•	37	41	78
2X69BD		•	•	37	45	82
2X69CC		•	•	41	41	82
2X69CA			•	41	32	73
2X69CB		•	•	41	37	78
2X69CD		•	•	41	45	86